

# TA74+

## TA74 GSM

## TA74 GSM IO

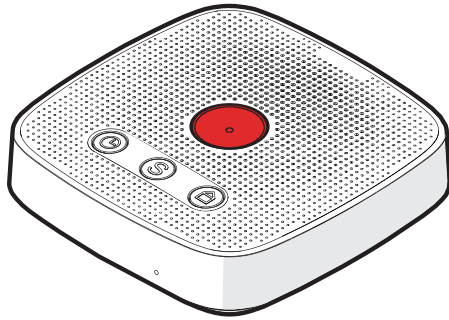

The TA74 product range offers multiple innovations that help you manage your telecare service easily, efficiently and economically. The devices can communicate through IP or analogue landline telephony. The TA74 GSM and TA74 GSM IO are additionally equipped with an internal GSM module and enable communication via the cellular network. The TA74+ can be upgraded by adding an internal GSM module.

Two "plug and play" programming methods are available, one through the TeleAlarm® Cloud Services platform and the other through the Configuration Manager software.

### System overview

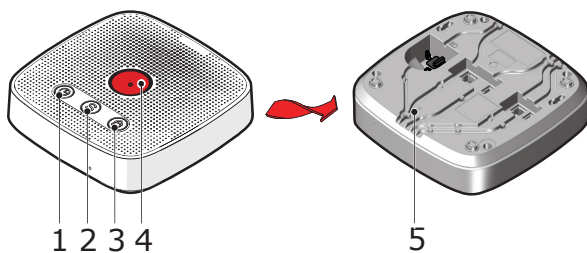

1. Daily button
2. Action button
3. Sign in / sign out button
4. Emergency call button
5. Maintenance button

### Functions

#### Multi-purpose buttons

In case of an emergency, the TA74 sends an alarm via the telephone network, or via LAN/Ethernet connection, either to an alarm receiving centre or a private phone connection.

The emergency call is triggered by pressing the Emergency call button on the TA74, or the button of the wireless transmitter that is delivered with the device. Up to 20 wireless transmitters can be paired to the TA74.

The Action button is a multi-purpose trigger: It can be pressed to cancel an unintentionally triggered alarm during the pre-alarm time, but it can also be configured to be used as a service button.

- Quick and easy programming via intuitive cloud programming
- Various communication protocols
- Vocal guidance
- First-class audio quality
- Best of modern communication options with Ethernet/VoIP, PSTN and GSM/GPRS/UMTS
- Always up to date via software remote updates
- Activity monitoring
- Vocal reminders
- Easy care - easy to clean and waterproof in accordance with IP32
- 100 % high-quality ABS material in premium white

When the TA74 has an error (message), pressing the Action button repeats the status announcement.

Pressing the Sign in / sign out button tells the TA74 whether the user is currently at home or not.

Finally, the TA74 includes a built-in activity monitor. This ensures that an emergency call is sent automatically

- if the Daily button is not pressed,
- if no activity is detected during a preset period of time.

#### Multiple protocols

The TA74 is capable of multiple protocols and therefore compatible with most telecare monitoring solutions. The TA74 can also be operated with IP connections, cellular networks and multiple legacy phone protocols.

#### Multiple programming possibilities

The TA74 can be programmed via the TeleAlarm® Cloud Services platform (LAN/Ethernet, analogue telephony or cellular network) or via the Configuration Manager software (local computer). This cloud or local programming is a "plug and play" process, sparing installers time and effort.

The TA74 can also be programmed via a compatible alarm receiving centre.

#### Vocal reminders

Three reminder messages can be recorded. Each notification can be automatically played on a configured day and at a configured time. It is repeated every 20 seconds until the Daily button is pressed or the preset time has elapsed. If the reminder message is not acknowledged, the device can send an alert to the alarm receiving centre.

#### Internal input/output

The TA74 GSM IO is equipped with a wired input/output connection. The connection can be used as an input, e.g. for a mechanical pull switch or motion detector, or as an output to operate an external device, e.g. a door opener.

#### Interactivity with wireless transmitters and detectors

A wide range of wireless transmitters and detectors can be used with the TA74, for example the Tx Transmitter, the wireless motion detector or the wireless smoke detector.

## Certifications and approvals

LVD 2014-35-EU, EMC 2014-30-EU, RED 2014/53/EU, RoHS 2011/65/EU.

EN 50134-1, EN 50134-2, EN 50134-3, EN 50134-5

EN 301489-1 V2.1.1

EN 301489-3 V1.6.1

EN 62368-1

EN 62479

EN 50130-4

EN 55032

EN 301 511 V12.5.1 (for GSM module only)

EN 301 908-2 V11.1.1 (for GSM module only)

EN 301 489-7 V1.3.1 (for GSM module only)

EN 301 489-24 V1.5.1 (for GSM module only)

EN 300220-2 V3.1.1 Category 1 radio receiver

Conducted sensitivity typ. -115 dBm

Field sensitivity < 36 dBµV/m

## Approval by healthcare providers

**TA74 GSM Pos. No. Pflegehilfsmittelverzeichnis (register of care aids):**  
 52.40.01.1095

**TA74 GSM IO Pos. No. Pflegehilfsmittelverzeichnis (register of care aids):**  
 52.40.01.1096

## Scope of delivery

Quantity	Component
1	Pre-installed rechargeable battery
1	Pre-installed internal antenna for cellular network
1	Built-in GSM/GPRS module: 2G dual band 900/1800 MHz and UMTS (3G) B1/B8 (TA74 GSM and TA74 GSM IO only)
1	Internal wired I/O (1 input and 1 relay output) (TA74 GSM IO only)
1	Wireless transmitter including CR2430 battery and necklace or bracelet
1	Power adapter
1	Optional telephone cable and/or network connection cable
1	Optional manual for technicians/installers
1	Quick Guide for users

## TA74 technical specifications

Dimensions (H x W x D)	50 x 191 x 191 mm
Weight	Approx. 0.6 kg
Permissible temperature range (environment / storage)	+5 °C to +40 °C -20 °C to +60 °C
Maximum relative humidity	93 %
Altitude	Up to 5000 m
Switched-mode power supply	AC Adapter 100 – 240 V AC, 50/60 Hz, 0.4 A Input, 6.1 V DC, 1.6 A Output
Current consumption in standby mode	Approx. 160 mA with power supply. Approx. 35 mA on battery
Unit battery	3.6 V NiMH battery, 2.2 Ah
Battery operating time	Min. 48 hours with one 30-minute call (TA74+ only). Min. 36 h with one 30-minute call (TA74 GSM and TA74 GSM IO). All values on date of purchase with a fully charged battery.
Communication connections	Ethernet/VoIP, GSM/GPRS/UMTS, PSTN
Receiver	Complies with category 1 as specified by EN 300220-1 V3.1.1
Frequency	869.2125 MHz (EU carephone frequency)
Environmental class	Class 1 as specified by EN 50134-3
Degree of protection	IP32 (IP30 wall mounting)
Max. number of wireless transmitters and detectors	20
Programmable call destinations	10 call destinations freely assignable to any type of trigger group
Voice message	Recordable, max. 10 seconds
Volume settings	8 levels
Emergency call protocols	Multi-protocol (SCAIP, RBIP, SIP, telephone, RB2000, RB2000E, TTnew+, CPC, BS8521)
Programming options	<ul style="list-style-type: none"> <li>• Remote programming via TeleAlarm® Cloud Services</li> <li>• Configuration Manager</li> <li>• Remote programming from alarm receiving centre</li> <li>• Service mode</li> </ul>
Hands-free range	Min. 15 m to TA74 (voice possibility when telephone is on-hook)

Self-test function/test call	<ul style="list-style-type: none"> <li>• PSTN: Freely selectable from 1 to 28 days.</li> <li>• LAN connection: Freely selectable from 1 to 999 hours</li> </ul>
Available languages	Dutch, English, French, German, Spanish, and tone only
User guidance	Synthetic speech and LED indication
User assistant	"Synthetic speech disabled" mode
Connectivity	<ul style="list-style-type: none"> <li>• LAN/Ethernet connection (10/100 Mbps)</li> <li>• Phone line (PSTN)</li> <li>• External telephone</li> <li>• micro-SIM card socket</li> <li>• Internal I/O (TA74 GSM IO only)</li> </ul>
SIM card size	Micro-SIM (15 mm x 12 mm)
Cellular network	2G GSM: GSM900, DCS1800 3G UMTS: B1 (1200), B8 (900)
Vocal reminders	Three recordable reminder messages (length: 15 seconds) (programming of day/time of playback)

## Technical specifications of wireless transmitter

Dimensions (H x D)	11 x 41 mm
Weight	15 g
Permissible temperature range	Operation: -10 °C to +55 °C Storage: -20 °C to +80 °C
Electrical power supply	Replaceable lithium battery CR2430
Current consumption	Transmission power: max. 22 mA Quiescent mode: max. 3 µA
Battery lifetime	Approx. 5 years if one emergency call is triggered per day. Automatic radio link and battery monitoring every 21 hours
Frequency	869.2125 MHz (EU carephone frequency)
Stability (0 °C to +55 °C)	< 2.5 kHz
Modulation	FSK
Antenna	Integrated loop
Radiated intensity	Approx. 320 µW
Degree of protection	IP67 in accordance with IEC 60529
Environmental class	II
Maximum range	<ul style="list-style-type: none"> <li>• Inside buildings: 30 – 50 m (depending on the building structure)</li> <li>• In the open air: max. 300 m</li> </ul>

TeleAlarm SA  
Rue du Pont 23  
2300 La Chaux-de-Fonds  
Switzerland  
www.telealarm.com

TeleAlarm Europe GmbH  
Hertzstraße 2  
04329 Leipzig  
Germany

© Copyright TeleAlarm SA, 2020

Contact in UK:  
Tel.: +44 (0) 333 0124392  
info-uk@telealarm.com